

ORDINANCE NO. 2002-50  
AMENDMENT TO ORDINANCE 91-04  
NASSAU COUNTY, FLORIDA

WHEREAS, on the 28th day of January, 1991, the Board of County Commissioners, Nassau County, Florida, did adopt Ordinance No. 91-04, an Ordinance Enacting and Establishing the Comprehensive Land Use Map and the Future Land Use Map for the unincorporated portion of Nassau County, Florida; and

WHEREAS, the Board of County Commissioners seeks to re-classify land designation on the Land Use Map from Medium Density Residential to Commercial; and

WHEREAS, the Board of County Commissioners held a public hearing on September 30, 2002 and on October 21, 2002; and

WHEREAS, the property is located on the north side of Amelia Island Parkway between Amelia Road and South 14<sup>th</sup> Street north of the airport, Fernandina Beach, Florida, area; and

WHEREAS, the Board of County Commissioners finds that the amendment to the Future Land Use Map and reclassification is consistent with the overall Comprehensive Land Use Map and orderly development of Nassau County, Florida, and the specific area.

NOW, THEREFORE, BE IT ORDAINED, by the Board of County Commissioners of Nassau County, Florida, this 21<sup>st</sup> day of October, 2002:

1. **SECTION 1. PROPERTY RECLASSIFIED.** The real property described in Section 2 is reclassified from Medium Density Residential to Commercial on the Future Land Use Map of Nassau County.

2. **SECTION 2. OWNER AND DESCRIPTION.** The land reclassified by this Ordinance is owned by Nancy Hornbuckle, owner, and is described as follows:

See Exhibit "A" attached hereto and made a part hereof by specific reference.

3. **SECTION 3.** This amendment is made a small-scale amendment pursuant to Florida Statutes, Section 163.3187.

4. **SECTION 4. EFFECTIVE DATE.** The effective date of this small-scale amendment shall be thirty-one days after adoption, unless the amendment is challenged pursuant to Section 163.3187(3), Florida Statutes. If challenged, the effective date of this amendment shall be the date a final order is issued by the Department of Community Affairs, or the Administration Commission, finding that the amendment is in compliance with Section 163.3184, Florida Statutes.

BOARD OF COUNTY COMMISSIONERS  
NASSAU COUNTY, FLORIDA

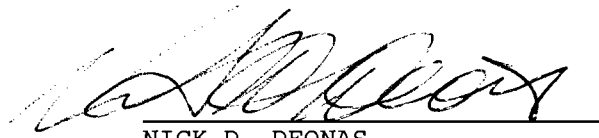

NICK D. DEONAS  
Its: Chairman

ATTEST:

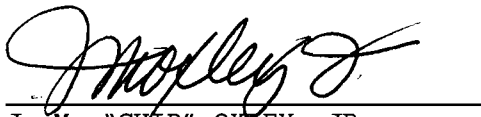

J. M. "CHIP" OXLEY, JR.  
Its: Ex-Officio Clerk

Approved as to form by the  
Nassau County Attorney:



MICHAEL S. MULLIN



# MANZIE & DRAKE LAND SURVEYING



Michael A. Manzie, P.L.S. • Frank L. Bowen, P.S.M. • Vernon N. Drake, P.S.M.

**EXHIBIT A**  
**LEGAL DESCRIPTION:**

PREPARED FOR AUSTIN & NANCY HORNSBUCKLE  
JANUARY 16, 2002

THE WEST ONE-HALF (W1/2) OF THE SOUTH ONE-HALF (S1/2) OF THE SOUTH ONE-HALF (S1/2) OF LOT 6, "OCEAN BREEZE", A SUBDIVISION OF SECTION 3, TOWNSHIP 2 NORTH, RANGE 28 EAST, NASSAU COUNTY, FLORIDA, ACCORDING TO THE PLAT THEREOF RECORDED IN PLAT BOOK 1, PAGE 10, OF THE PUBLIC RECORDS OF NASSAU COUNTY, FLORIDA.

TOGETHER WITH THE FOLLOWING DESCRIBED TRACT OF LAND BEING A PORTION OF HIRTH ROAD, A PORTION OF LOT 105, "OCEAN BREEZE", A SUBDIVISION OF SECTION 3, TOWNSHIP 2 NORTH, RANGE 28 EAST, NASSAU COUNTY, FLORIDA, ACCORDING TO THE PLAT THEREOF RECORDED IN PLAT BOOK 1, PAGE 5, OF THE PUBLIC RECORDS OF NASSAU COUNTY, FLORIDA AND A PORTION OF SECTION 7, TOWNSHIP 2 NORTH, RANGE 28 EAST, NASSAU COUNTY, FLORIDA, BEING MORE PARTICULARLY DESCRIBED AS FOLLOWS:

BEGIN AT THE SOUTHEAST CORNER OF THE WEST ONE-HALF (W1/2) OF THE SOUTH ONE-HALF (S1/2) OF LOT 6, "OCEAN BREEZE", A SUBDIVISION OF SECTION 3, TOWNSHIP 2 NORTH, RANGE 28 EAST, NASSAU COUNTY, FLORIDA, ACCORDING TO THE PLAT THEREOF RECORDED IN PLAT BOOK 1, PAGE 10, OF THE PUBLIC RECORDS OF NASSAU COUNTY, FLORIDA; THENCE SOUTH 01°19'59" WEST, ALONG THE SOUTHERLY EXTENSION OF THE EAST LINE OF SAID WEST ONE-HALF (W1/2) OF THE SOUTH ONE-HALF (S1/2) OF LOT 6, A DISTANCE OF 25.00 FEET TO THE SOUTHERLY RIGHT-OF-WAY LINE OF HIRTH ROAD; THENCE SOUTH 01°45'52" WEST A DISTANCE OF 195.64 FEET TO A 4"x4" CONCRETE MONUMENT; THENCE SOUTH 09°39'53" WEST A DISTANCE OF 75.11 FEET TO A 4"x4" CONCRETE MONUMENT LOCATED ON THE NORTHERLY RIGHT-OF-WAY LINE OF COUNTY ROAD NO. 105A (AMELIA ISLAND PARKWAY) A 100 FOOT RIGHT-OF-WAY AND THE BEGINNING OF A CURVE CONCAVE TO THE NORTHEAST HAVING A RADIUS OF 269.62 FEET; THENCE WESTERLY AND NORTHERLY ALONG THE ARC OF SAID CURVE AND ALONG SAID RIGHT-OF-WAY LINE, THROUGH A CENTRAL ANGLE OF 88°30'24" AN ARC DISTANCE OF 416.49 FEET AND BEING SUBTENDED BY A CHORD BEARING NORTH 42°45'39" WEST A DISTANCE OF 376.30 FEET; THENCE NORTH 01°30'26" EAST A DISTANCE OF 25.25 FEET TO THE NORTHERLY RIGHT-OF-WAY LINE OF HIRTH ROAD; THENCE SOUTH 88°33'00" EAST, ALONG THE NORTHERLY RIGHT-OF-WAY LINE OF HIRTH ROAD, A DISTANCE OF 274.12 FEET TO THE POINT OF BEGINNING, EXCLUDING THESE PROPERTIES PRESENT IN SECTION 7.

SUBJECT TO POSSIBLE RIGHT-OF-WAY FOR HIRTH ROAD WHICH MAY OR MAY NOT BE ABANDONED.

CONTAINING 1.61 ACRES MORE OR LESS.

CPA 02-013 / R02 -022

THIS MAP WAS PREPARED BY THE PLANNING DEPARTMENT OF THE CITY OF FERNANDINA BEACH, FLORIDA, AND IS SUBJECT TO THE APPROVAL OF THE BOARD OF CITY COMMISSIONERS.

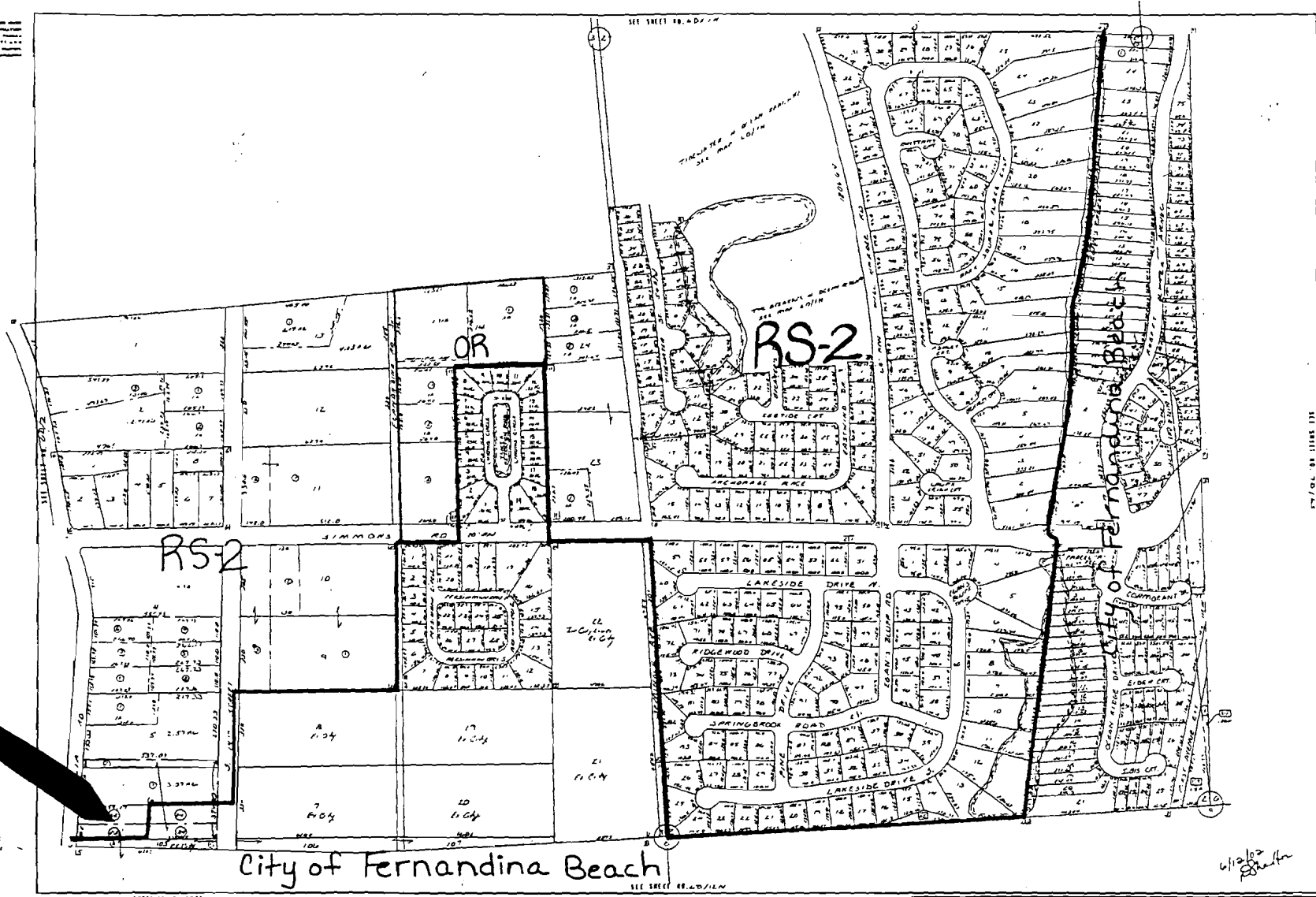

ADDITIONAL CITY COMMISSIONERS' RESOLUTIONS ARE AVAILABLE AT THE CITY CLERK'S OFFICE.

**SUBDIVISION INDEX**

NO.	NAME	Y.B.	PT.
1.	BEACH'S BEACH UNIT 1	73	021A
2.	BEACH'S BEACH UNIT 2	73	021B
3.	OCEAN RIDGE	73	0100A
4.	BEACH'S BEACH UNIT 3	73	021C
5.	OCEAN RIDGE PHASE 2	73	0100B
6.	OCEAN RIDGE PHASE 3	73	0100C
7.	OCEAN RIDGE PHASE 4	73	0100D
8.	OCEAN RIDGE PHASE 5	73	0100E
9.	OCEAN RIDGE PHASE 6	73	0100F
10.	OCEAN RIDGE PHASE 7	73	0100G
11.	OCEAN RIDGE PHASE 8	73	0100H
12.	OCEAN RIDGE PHASE 9	73	0100I
13.	OCEAN RIDGE PHASE 10	73	0100J
14.	OCEAN RIDGE PHASE 11	73	0100K
15.	OCEAN RIDGE PHASE 12	73	0100L
16.	OCEAN RIDGE PHASE 13	73	0100M
17.	OCEAN RIDGE PHASE 14	73	0100N
18.	OCEAN RIDGE PHASE 15	73	0100O
19.	OCEAN RIDGE PHASE 16	73	0100P
20.	OCEAN RIDGE PHASE 17	73	0100Q
21.	OCEAN RIDGE PHASE 18	73	0100R
22.	OCEAN RIDGE PHASE 19	73	0100S
23.	OCEAN RIDGE PHASE 20	73	0100T
24.	OCEAN RIDGE PHASE 21	73	0100U
25.	OCEAN RIDGE PHASE 22	73	0100V
26.	OCEAN RIDGE PHASE 23	73	0100W
27.	OCEAN RIDGE PHASE 24	73	0100X
28.	OCEAN RIDGE PHASE 25	73	0100Y
29.	OCEAN RIDGE PHASE 26	73	0100Z
30.	OCEAN RIDGE PHASE 27	73	0100AA
31.	OCEAN RIDGE PHASE 28	73	0100AB
32.	OCEAN RIDGE PHASE 29	73	0100AC
33.	OCEAN RIDGE PHASE 30	73	0100AD
34.	OCEAN RIDGE PHASE 31	73	0100AE
35.	OCEAN RIDGE PHASE 32	73	0100AF
36.	OCEAN RIDGE PHASE 33	73	0100AG
37.	OCEAN RIDGE PHASE 34	73	0100AH
38.	OCEAN RIDGE PHASE 35	73	0100AI
39.	OCEAN RIDGE PHASE 36	73	0100AJ
40.	OCEAN RIDGE PHASE 37	73	0100AK
41.	OCEAN RIDGE PHASE 38	73	0100AL
42.	OCEAN RIDGE PHASE 39	73	0100AM
43.	OCEAN RIDGE PHASE 40	73	0100AN
44.	OCEAN RIDGE PHASE 41	73	0100AO
45.	OCEAN RIDGE PHASE 42	73	0100AP
46.	OCEAN RIDGE PHASE 43	73	0100AQ
47.	OCEAN RIDGE PHASE 44	73	0100AR
48.	OCEAN RIDGE PHASE 45	73	0100AS
49.	OCEAN RIDGE PHASE 46	73	0100AT
50.	OCEAN RIDGE PHASE 47	73	0100AU
51.	OCEAN RIDGE PHASE 48	73	0100AV
52.	OCEAN RIDGE PHASE 49	73	0100AW
53.	OCEAN RIDGE PHASE 50	73	0100AX
54.	OCEAN RIDGE PHASE 51	73	0100AY
55.	OCEAN RIDGE PHASE 52	73	0100AZ
56.	OCEAN RIDGE PHASE 53	73	0100BA
57.	OCEAN RIDGE PHASE 54	73	0100BB
58.	OCEAN RIDGE PHASE 55	73	0100BC
59.	OCEAN RIDGE PHASE 56	73	0100BD
60.	OCEAN RIDGE PHASE 57	73	0100BE
61.	OCEAN RIDGE PHASE 58	73	0100BF
62.	OCEAN RIDGE PHASE 59	73	0100BG
63.	OCEAN RIDGE PHASE 60	73	0100BH
64.	OCEAN RIDGE PHASE 61	73	0100BI
65.	OCEAN RIDGE PHASE 62	73	0100BJ
66.	OCEAN RIDGE PHASE 63	73	0100BK
67.	OCEAN RIDGE PHASE 64	73	0100BL
68.	OCEAN RIDGE PHASE 65	73	0100BM
69.	OCEAN RIDGE PHASE 66	73	0100BN
70.	OCEAN RIDGE PHASE 67	73	0100BO
71.	OCEAN RIDGE PHASE 68	73	0100BP
72.	OCEAN RIDGE PHASE 69	73	0100BQ
73.	OCEAN RIDGE PHASE 70	73	0100BR
74.	OCEAN RIDGE PHASE 71	73	0100BS
75.	OCEAN RIDGE PHASE 72	73	0100BT
76.	OCEAN RIDGE PHASE 73	73	0100BU
77.	OCEAN RIDGE PHASE 74	73	0100BV
78.	OCEAN RIDGE PHASE 75	73	0100BW
79.	OCEAN RIDGE PHASE 76	73	0100BX
80.	OCEAN RIDGE PHASE 77	73	0100BY
81.	OCEAN RIDGE PHASE 78	73	0100BZ
82.	OCEAN RIDGE PHASE 79	73	0100CA
83.	OCEAN RIDGE PHASE 80	73	0100CB
84.	OCEAN RIDGE PHASE 81	73	0100CC
85.	OCEAN RIDGE PHASE 82	73	0100CD
86.	OCEAN RIDGE PHASE 83	73	0100CE
87.	OCEAN RIDGE PHASE 84	73	0100CF
88.	OCEAN RIDGE PHASE 85	73	0100CG
89.	OCEAN RIDGE PHASE 86	73	0100CH
90.	OCEAN RIDGE PHASE 87	73	0100CI
91.	OCEAN RIDGE PHASE 88	73	0100CJ
92.	OCEAN RIDGE PHASE 89	73	0100CK
93.	OCEAN RIDGE PHASE 90	73	0100CL
94.	OCEAN RIDGE PHASE 91	73	0100CM
95.	OCEAN RIDGE PHASE 92	73	0100CN
96.	OCEAN RIDGE PHASE 93	73	0100CO
97.	OCEAN RIDGE PHASE 94	73	0100CP
98.	OCEAN RIDGE PHASE 95	73	0100CQ
99.	OCEAN RIDGE PHASE 96	73	0100CR
100.	OCEAN RIDGE PHASE 97	73	0100CS
101.	OCEAN RIDGE PHASE 98	73	0100CT
102.	OCEAN RIDGE PHASE 99	73	0100CU
103.	OCEAN RIDGE PHASE 100	73	0100CV
104.	OCEAN RIDGE PHASE 101	73	0100CW
105.	OCEAN RIDGE PHASE 102	73	0100CX
106.	OCEAN RIDGE PHASE 103	73	0100CY
107.	OCEAN RIDGE PHASE 104	73	0100CZ
108.	OCEAN RIDGE PHASE 105	73	0100DA
109.	OCEAN RIDGE PHASE 106	73	0100DB
110.	OCEAN RIDGE PHASE 107	73	0100DC
111.	OCEAN RIDGE PHASE 108	73	0100DD
112.	OCEAN RIDGE PHASE 109	73	0100DE
113.	OCEAN RIDGE PHASE 110	73	0100DF
114.	OCEAN RIDGE PHASE 111	73	0100DG
115.	OCEAN RIDGE PHASE 112	73	0100DH
116.	OCEAN RIDGE PHASE 113	73	0100DI
117.	OCEAN RIDGE PHASE 114	73	0100DJ
118.	OCEAN RIDGE PHASE 115	73	0100DK
119.	OCEAN RIDGE PHASE 116	73	0100DL
120.	OCEAN RIDGE PHASE 117	73	0100DM
121.	OCEAN RIDGE PHASE 118	73	0100DN
122.	OCEAN RIDGE PHASE 119	73	0100DO
123.	OCEAN RIDGE PHASE 120	73	0100DP
124.	OCEAN RIDGE PHASE 121	73	0100DQ
125.	OCEAN RIDGE PHASE 122	73	0100DR
126.	OCEAN RIDGE PHASE 123	73	0100DS
127.	OCEAN RIDGE PHASE 124	73	0100DT
128.	OCEAN RIDGE PHASE 125	73	0100DU
129.	OCEAN RIDGE PHASE 126	73	0100DV
130.	OCEAN RIDGE PHASE 127	73	0100DW
131.	OCEAN RIDGE PHASE 128	73	0100DX
132.	OCEAN RIDGE PHASE 129	73	0100DY
133.	OCEAN RIDGE PHASE 130	73	0100DZ
134.	OCEAN RIDGE PHASE 131	73	0100EA
135.	OCEAN RIDGE PHASE 132	73	0100EB
136.	OCEAN RIDGE PHASE 133	73	0100EC
137.	OCEAN RIDGE PHASE 134	73	0100ED
138.	OCEAN RIDGE PHASE 135	73	0100EE
139.	OCEAN RIDGE PHASE 136	73	0100EF
140.	OCEAN RIDGE PHASE 137	73	0100EG
141.	OCEAN RIDGE PHASE 138	73	0100EH
142.	OCEAN RIDGE PHASE 139	73	0100EI
143.	OCEAN RIDGE PHASE 140	73	0100EJ
144.	OCEAN RIDGE PHASE 141	73	0100EK
145.	OCEAN RIDGE PHASE 142	73	0100EL
146.	OCEAN RIDGE PHASE 143	73	0100EM
147.	OCEAN RIDGE PHASE 144	73	0100EN
148.	OCEAN RIDGE PHASE 145	73	0100EO
149.	OCEAN RIDGE PHASE 146	73	0100EP
150.	OCEAN RIDGE PHASE 147	73	0100EQ
151.	OCEAN RIDGE PHASE 148	73	0100ER
152.	OCEAN RIDGE PHASE 149	73	0100ES
153.	OCEAN RIDGE PHASE 150	73	0100ET
154.	OCEAN RIDGE PHASE 151	73	0100EU
155.	OCEAN RIDGE PHASE 152	73	0100EV
156.	OCEAN RIDGE PHASE 153	73	0100EW
157.	OCEAN RIDGE PHASE 154	73	0100EX
158.	OCEAN RIDGE PHASE 155	73	0100EY
159.	OCEAN RIDGE PHASE 156	73	0100EZ
160.	OCEAN RIDGE PHASE 157	73	0100FA
161.	OCEAN RIDGE PHASE 158	73	0100FB
162.	OCEAN RIDGE PHASE 159	73	0100FC
163.	OCEAN RIDGE PHASE 160	73	0100FD
164.	OCEAN RIDGE PHASE 161	73	0100FE
165.	OCEAN RIDGE PHASE 162	73	0100FF
166.	OCEAN RIDGE PHASE 163	73	0100FG
167.	OCEAN RIDGE PHASE 164	73	0100FH
168.	OCEAN RIDGE PHASE 165	73	0100FI
169.	OCEAN RIDGE PHASE 166	73	0100FJ
170.	OCEAN RIDGE PHASE 167	73	0100FK
171.	OCEAN RIDGE PHASE 168	73	0100FL
172.	OCEAN RIDGE PHASE 169	73	0100FM
173.	OCEAN RIDGE PHASE 170	73	0100FN
174.	OCEAN RIDGE PHASE 171	73	0100FO
175.	OCEAN RIDGE PHASE 172	73	0100FP
176.	OCEAN RIDGE PHASE 173	73	0100FQ
177.	OCEAN RIDGE PHASE 174	73	0100FR
178.	OCEAN RIDGE PHASE 175	73	0100FS
179.	OCEAN RIDGE PHASE 176	73	0100FT
180.	OCEAN RIDGE PHASE 177	73	0100FU
181.	OCEAN RIDGE PHASE 178	73	0100FV
182.	OCEAN RIDGE PHASE 179	73	0100FW
183.	OCEAN RIDGE PHASE 180	73	0100FX
184.	OCEAN RIDGE PHASE 181	73	0100FY
185.	OCEAN RIDGE PHASE 182	73	0100FZ
186.	OCEAN RIDGE PHASE 183	73	0100GA
187.	OCEAN RIDGE PHASE 184	73	0100GB
188.	OCEAN RIDGE PHASE 185	73	0100GC
189.	OCEAN RIDGE PHASE 186	73	0100GD
190.	OCEAN RIDGE PHASE 187	73	0100GE
191.	OCEAN RIDGE PHASE 188	73	0100GF
192.	OCEAN RIDGE PHASE 189	73	0100GG
193.	OCEAN RIDGE PHASE 190	73	0100GH
194.	OCEAN RIDGE PHASE 191	73	0100GI
195.	OCEAN RIDGE PHASE 192	73	0100GJ
196.	OCEAN RIDGE PHASE 193	73	0100GK
197.	OCEAN RIDGE PHASE 194	73	0100GL
198.	OCEAN RIDGE PHASE 195	73	0100GM
199.	OCEAN RIDGE PHASE 196	73	0100GN
200.	OCEAN RIDGE PHASE 197	73	0100GO
201.	OCEAN RIDGE PHASE 198	73	0100GP
202.	OCEAN RIDGE PHASE 199	73	0100GQ
203.	OCEAN RIDGE PHASE 200	73	0100GR
204.	OCEAN RIDGE PHASE 201	73	0100GS
205.	OCEAN RIDGE PHASE 202	73	0100GT
206.	OCEAN RIDGE PHASE 203	73	0100GU
207.	OCEAN RIDGE PHASE 204	73	0100GV
208.	OCEAN RIDGE PHASE 205	73	0100GW
209.	OCEAN RIDGE PHASE 206	73	0100GX
210.	OCEAN RIDGE PHASE 207	73	0100GY
211.	OCEAN RIDGE PHASE 208	73	0100GZ
212.	OCEAN RIDGE PHASE 209	73	0100HA
213.	OCEAN RIDGE PHASE 210	73	0100HB
214.	OCEAN RIDGE PHASE 211	73	0100HC
215.	OCEAN RIDGE PHASE 212	73	0100HD
216.	OCEAN RIDGE PHASE 213	73	0100HE
217.	OCEAN RIDGE PHASE 214	73	0100HF
218.	OCEAN RIDGE PHASE 215	73	0100HG
219.	OCEAN RIDGE PHASE 216	73	0100HH
220.	OCEAN RIDGE PHASE 217	73	0100HI
221.	OCEAN RIDGE PHASE 218	73	0100HJ
222.	OCEAN RIDGE PHASE 219	73	0100HK
223.	OCEAN RIDGE PHASE 220	73	0100HL
224.	OCEAN RIDGE PHASE 221	73	0100HM
225.	OCEAN RIDGE PHASE 222	73	0100HN
226.	OCEAN RIDGE PHASE 223	73	0100HO
227.	OCEAN RIDGE PHASE 224	73	0100HP
228.	OCEAN RIDGE PHASE 225	73	0100HQ
229.	OCEAN RIDGE PHASE 226	73	0100HR
230.	OCEAN RIDGE PHASE 227	73	0100HS
231.	OCEAN RIDGE PHASE 228	73	0100HT
232.	OCEAN RIDGE PHASE 229	73	0100HU
233.	OCEAN RIDGE PHASE 230	73	0100HV
234.	OCEAN RIDGE PHASE 231	73	0100HW
235.	OCEAN RIDGE PHASE 232	73	0100HX
236.	OCEAN RIDGE PHASE 233	73	0100HY
237.	OCEAN RIDGE PHASE 234	73	0100HZ
238.	OCEAN RIDGE PHASE 235	73	0100IA
239.	OCEAN RIDGE PHASE 236		